

**Product:** KLUDI E-GO electronic and single-lever controlled sink mixer DN 10

**Ref.:** 422150575

### Product description

electronic and single-lever controlled sink mixer DN 10  
solid lever, single hole mounted  
flow class Z, Cache-aerator M 16,5 x I  
water flow regulator 8,0 l/min  
ceramic cartridge with hot water safety device  
adjustable temperature through lever employment  
sensory operation, automatic sensory measuring  
electronic unit with battery control device  
6 V Lithium Battery CR-P2, with magnet-cartridge unit,  
swivelling spout (360°), removable spout,  
back flow preventer with dirt-catcher sieve, protected  
against back flow, rapid installation set, flexible high  
pressure supply tubes G 3/8

Finishes:  
05 chrome

### Advertisement

- \* KLUDI GmbH & Co KG, KLUDI E-GO Electronic and single-lever controlled sink mixer DN 10 Art. Nr. 422150575
- \*\* battery powered (6 V Lithium battery CR-P2)
- \*\*\* ceramic cartridge with hot water safety device, DIN EN 817
- \*\*\*\* brass in compliance with DIN 50930-6

Electronic and single-lever controlled sink mixer, manufacturer type KLUDI GmbH & Co KG KLUDI E-GO Electronic and single-lever controlled sink mixer DN 10 item no. 422150575, DN 10, made of brass in compliance with DIN 50930-6, finish: 05 = chrome, as single hole mounted sink mixer, swivel spout with removable hand spout, with electronic controls or as single-lever mixer, in line with technical specifications DIN EN 817, with flexible high pressure supply tubes with W543/KTW/W270 approv. DVGW /CSTB / KIWA / WRAS approval length in mm 420 with G 3/8 union nuts, noise behaviour in compliance with DIN 4109 Group I, Cache aerator M 16.5 x I, shower hose with W270/KTW A hygiene certification, with water flow regulator 8,0 l/min, battery powered using 6 V Lithium battery CR-P2, control electronics with programming options, activation optoelectronic or via integrated ceramic cartridge with hot water safety device, operation at pressures over 5 bar requires a pressure reducing valve, flow class Z for single-lever mixer operation / approx. 4,1 l/min for electronic activation, max. warm water intake temperature 65 °C (as scald protection), with activatable cleaning mode for maintenance purposes, with magnet valve and dirt-catcher sieves as integrated unit within the fitting, with integrated sensor window, automatic valve closed after 90 sec. if optical unit under sensory operation, with backflow preventer on the intakes, with rapid installation set, protected against back flow, spout projection 236 mm, spout height 250 mm, height complete 472 mm, for pressure type water heaters and for continuous line water heaters, PN 10,

### Product picture



### Dimensional drawing

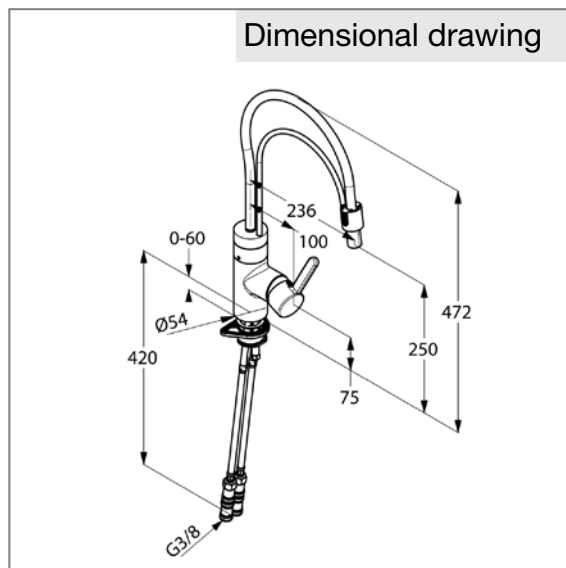

### Flow rate diagram

