

**Product:** KLUDI THERMOSTAT concealed thermostatic mixer body, pre- installation set DN 15

**Ref.:** 35156

**Product description**

Thermostat concealed thermostatic mixer body  
 pre-installation set  
 without trim set  
 in wall installation  
 flow class B  
 ceramic headpart 90°  
 dirt-catcher sieve  
 back flow preventer  
 noise group I  
 PA-IX 8409/IB

**Advertisement**

- \* KLUDI GmbH & Co KG KLUDI concealed thermostat mixer body item no. 35156
- \*\* thermostat control element, DIN EN 1111
- \*\*\* brass, DIN EN 50930-6
- \*\*\*\* ceramic headpart 90°, DIN EN 200

concealed thermostat mixer body, manufacturer KLUDI GmbH & Co KG KLUDI concealed thermostat mixer body item no. 35156, DN 15, brass, ceramic headpart 90°, for installation depth 63 - 83 mm, type: concealed thermostat mixer body DN 15, flow class B max. 0,42 l/s, noise level DIN EN 4109 group I, report no. PA- IX 8409, without trim set, dirt catcher sieve, connectors 1/2 inch, outlets 1/2 inch, with shut-off valve, with back flow preventer, for pressure type water heater, for continuous line heater, PN 10,

**Product picture**



**Dimensional drawing**

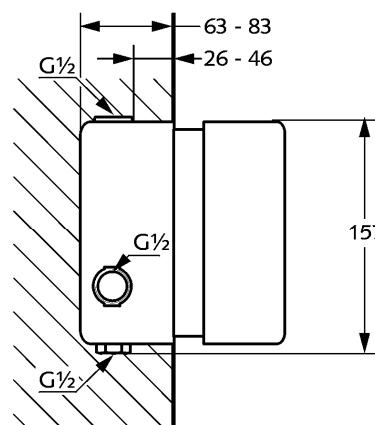

**Flow rate diagram**

