

Product: KLUDI MEDI CARE wall mounted single lever mixer DN 15

Ref.: 349200524

Product description

wall mounted single lever mixer DN 15
arm lever for hospital purpose
wall fastening
flow class Z
flow rate 8 l/min
care jet-spray regulator M 24 x I
safety ceramic cartridges with hot water safety stop
movable and lockable spout
projection 245 mm
S unions
noise group I
PA-IX 9573/IZ

Finishes:
05 chrome

Product picture



Advertisement

- * KLUDI GmbH & Co. KG KLUDI MEDI-CARE single lever wall mixer item no. 349200524
- ** safety ceramic cartridge with hot water safety stop Ø 35 mm, DIN EN 817
- *** chrome plated brass, DIN 50930-6

single lever wall mixer DN 15, manufacturer KLUDI GmbH & Co. KG KLUDI MEDI-CARE single lever wall mixer item no. 349200524, DN 15, chrome plated brass, safety ceramic cartridge with hot water safety stop Ø 35 mm, flow rate 8 l/min, type: single lever wall mixer DN 15, movable and lockable spout, PCA care- non aerated M 24 x I, noise level DIN EN 4109 group I, report no. PA- IX 9573 / IZ, lever projection 160 mm, S unions 1/2 x 3/4 inch, nozzle projection 245 mm, overall length 209 mm, arm lever for hospital purpose, for pressure type water heater, for continuous line heater, PN 10,

Dimensional drawing

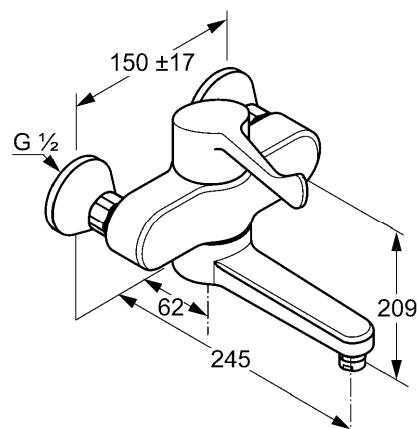

Flow rate diagram

