

KLUDI-NOVA FONTE PURISTIC BASIN MIXER DN 15

201183915

Basin Mixers

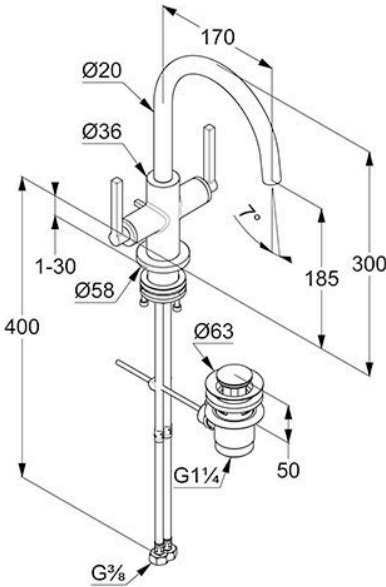



Technical Specification

Series:	KLUDI-NOVA FONTE
Color:	matt black
Dimensions:	18.8 x 10.2 x 30mm
Height:	30
Lever Type:	Double
Water Efficiency:	Moderate
Installation Type:	Deck-mounted

Name:

Dimensions: All dimensions in mm. Tolerance of vitreous china & fireclay items: $\hat{A}\pm 5\%$ for below 200mm and $\hat{A}\pm 3\%$ for above 200mm; for all other items tolerance $\hat{A}\pm 1\%$. Note: Due to a continuing development program to improve design and performance, the manufacturer reserves all rights to vary specifications without prior information. Please note accessories are for photographic use only.

-
- KLUDI-NOVA FONTE
 - Puristic
 - basin mixer DN 15
 - wing handles, metal
 - single hole mounted
 - Aerator M18,5 x 1 PCA laminar
 - Soft-Start ceramic headpart 90
 - Flow rate 5.6 l / min at 3 bar
 - swivelling (150/ 360) or
 - lockable spout
 - flexible pressure hoses G 3/8
 - with shank fastening
 - metal pop-up waste G 1 1/4
 - spout height lower edge 185 mm

Dimensions: All dimensions in mm. Tolerance of vitreous china & fireclay items: $\hat{A}\pm 5\%$ for below 200mm and $\hat{A}\pm 3\%$ for above 200mm; for all other items tolerance $\hat{A}\pm 1\%$. Note: Due to a continuing development program to improve design and performance, the manufacturer reserves all rights to vary specifications without prior information. Please note accessories are for photographic use only.